

## AJR3-N Series Soft Starter(Inbuilt Bypass)



AJR3-N

### 1. Application

#### Using Press-fit type SCR(thyristor)

Compared with solder type, press-fit is more stronger and reliable and robust and long service life

#### Internal Bypass Contactor

Free of bypass contactor, save time and labor and space

#### Alloy high intensity body

Metal processing technology and oxidation technics Aluminum high strength body, anti-corrosion

#### Control unit & Internal power supply design

No need power supply for control unit, no three phase

#### Free of setting, fast arranging

No need to set for motor or internal intelligent process

#### "Pocket Size" Body

Integrated with bypass contactor, reduced 40% of the volume(Compared with AJR3-1000)

### 2. Electrical Parameters

Standard	GB 14048.6-2008/IEC 60947-4-2 : 2002	
Rated operational voltage	200~415V(-15%+10%)	
Max.length between soft starter and cable	300m	
Permissible ambient environment	Operation	-25°C~+60°C(consider reducing capacity if>40°C)
	Storage	-40°C~+70°C
Protection grade	IP20	
Rated power	50/60Hz	
Permissible installation height	5000m (start to reduce capacity for above 1000m)	
Starting frequency	≤ 15 times/hour (Class10 standard load)	

### 3. Product Dimensions

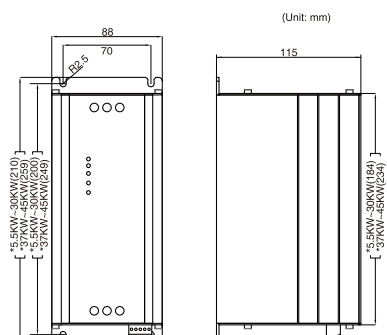

### 4. Installation Sketch

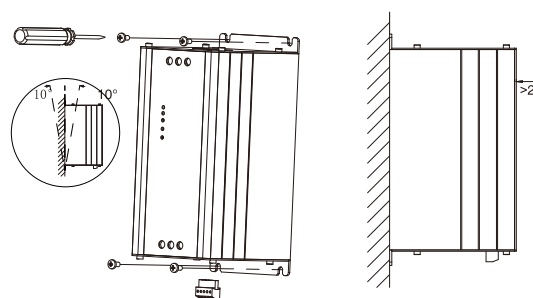

## 5. Terminal Description

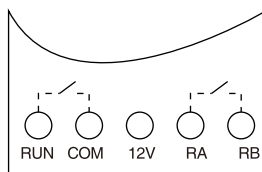

Terminal marking of major loop	Terminal name	Function description
L1,L2,L3	Mains input of major loop	Connect three-phase source
T1,T2,T3	Output connection of soft start	Connect three-phase motor

Terminal marking of control loop	Terminal name	Function description
RUN	Enable input	When closing run and com, start to operate When breaking run and com, motor slows down and halts
COM	Common port	Run and common port at 12V
12V	Power terminal	Interior power output terminal at 12V, 300mA at maximum, prohibit overload
RA,RB	Indication of working status	Working status: relay output, normally open contact, close during operation, break if stall or fault, relay capacity 250V/AC 0.3A

## 6. Power Diagram

Model	230V/KW	400V/KW	Rated current A
AJR3-N5R5	3	5.5	13
AJR3-N7R5	4	7.5	17
AJR3-N11	5.5	11	25
AJR3-N15	7.5	15	32
AJR3-N18	7.5	18.5	37
AJR3-N22	11	22	45
AJR3-N30	15	30	60
AJR3-N37	18.5	37	75
AJR3-N45	22	45	90

## 7. Parameter Setting

### Wiring steps

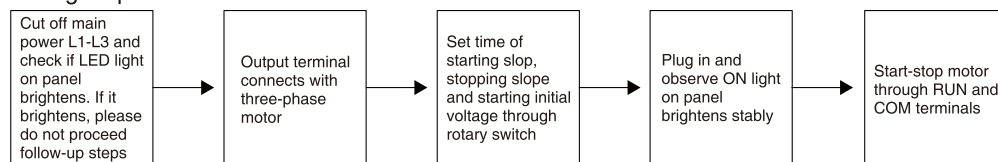

### Panel parameters

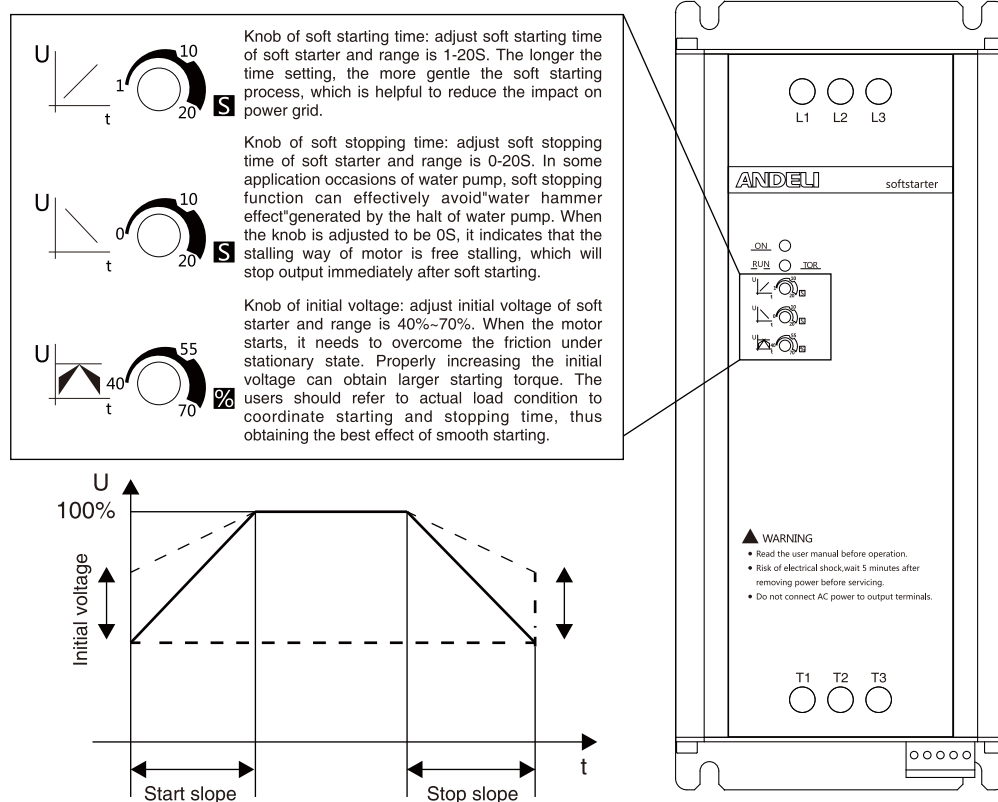

### Operation sequence diagram

