

# PRODUCT SELECTION REPORT

Model: XST50-200/92

Name: End Suction Centrifugal Pump



**LEO GROUP PUMP CO.,LTD.**

2024.7.31

Project Name: m

Personal Name: m  
Company Address:

Company Name:

Website: www.leopump.com  
Company Name:

Product Model: XST50-200/92  
LEO GROUP PUMP CO., LTD.

## Product Recommendations

Power(kW): 9.2      Flow(m<sup>3</sup>/h): 50  
Head(m): 42

Based on provided information and product parameters, LEO PUMP recommends model:  
**XST50-200/92**

## Introduce

### Application

Circulation and transfer of clean, chemically non-aggressive water and other liquids;  
Water supply & irrigation;  
Water circulation in air conditioning systems;  
Fire fighting system;

### Operating Conditions

Delivery: up to 210 m<sup>3</sup>/h;  
Head: up to 95 m;  
Liquid temperature: Standard -10°C to 85°C;  
Maximum operating pressure: 12 bar (PN12) Anti-clockwise rotation when facing pump's suction port  
Impeller: AISI304, HT200;  
Mechanical seal in compliance with DIN 24960  
Lubricated by internal recirculating pumped liquid; Counter flange available on request.

## Product Parameters

### Nameplate

Pump flow rate(m <sup>3</sup> /h):	50	Total manometric head H(m):	42
Overall efficiency(%):	73.2	Speed(rpm):	2900

### Technical

Motor power(kW):	9.2	Pump power input(kW):	7.82
Curve tolerance:	ISO9906 Appendix A	Maximum lift(m):	50.5
Minimum usage flow(m <sup>3</sup> /h):	5	Maximum use flow(m <sup>3</sup> /h):	75
Impeller diameter(mm):	198		

### Material

Impeller:	HT200	Pump body:	HT200
Chassis:		Rear end cover:	
Bracket:			
Mechanical seal:		Single mechanical seal	20-30

### Working conditions

Max. ambient temperature(°C):	40	Max. liquid temperature(°C):	85
Max. Operating Pressure(Mpa):	12bar		
Pumped medium:		Water or other liquids similar to water	

### Installation

Inlet&Outlet Diameter:	65-50		
Connection standard:		Flange connection	

### Motor

Motor phase:	Three phase	Protection class:	IP54
Motor poles:	2	Insulation class:	F
Motor power(kW) :	9.2	Frequency(Hz):	50
Rated voltage(V):	380	Rated current(A):	18.4
Drive end bearing:		Non-drive end bearing:	
Starting current(A):			

### Weight/Packaging

Gross weight(kg):	177	Package size(mm):	910*405*600
-------------------	-----	-------------------	-------------

### Area Range Parameters

Max Q(m³/h):	75	Allowable Minimum (m³/h):	5
Allowable Maximum (m³/h):	75	Min Value Optimal area (m³/h):	45
Max Value Optimal area (m³/h):	55		

## Performance Curve

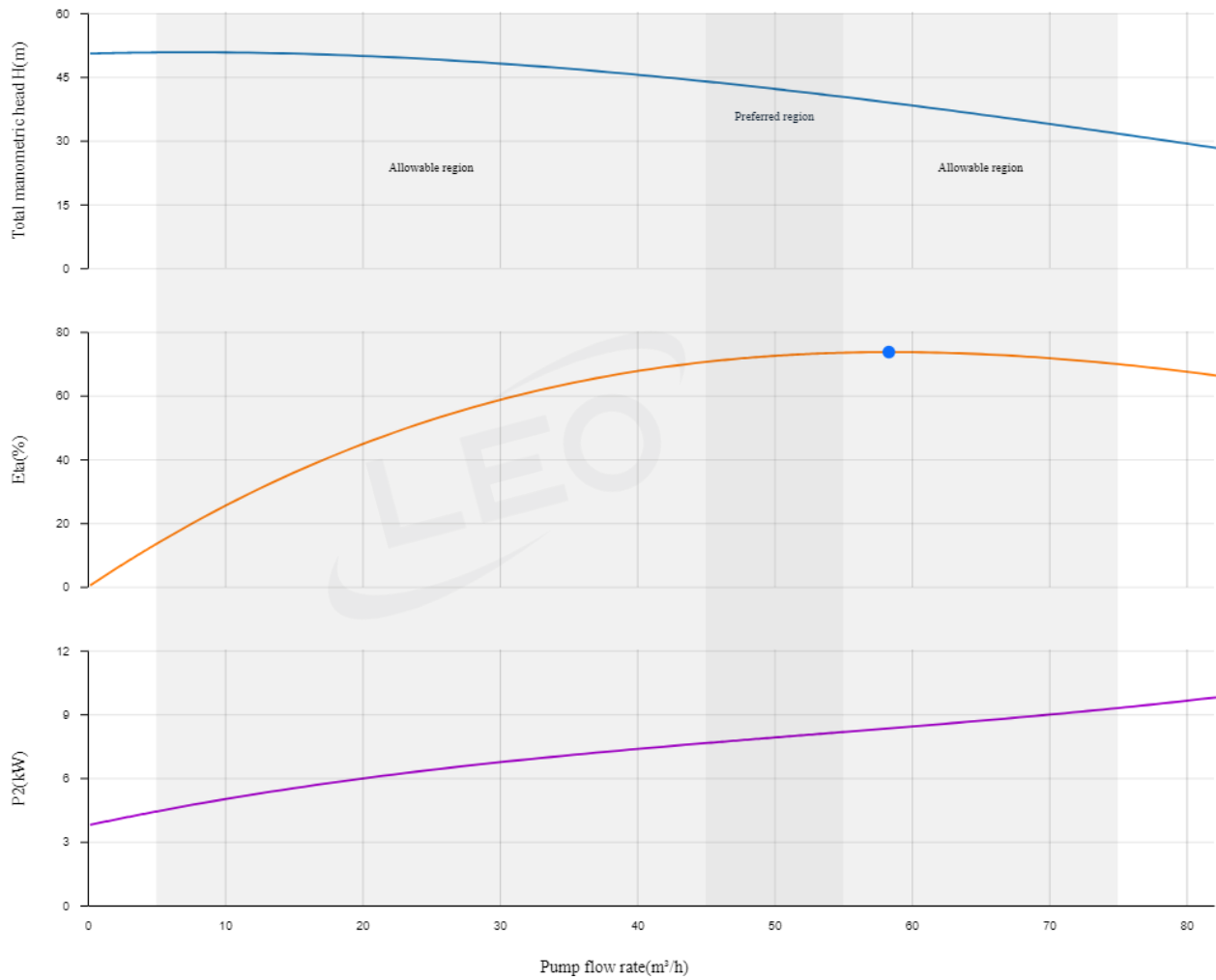

## Shape & Size

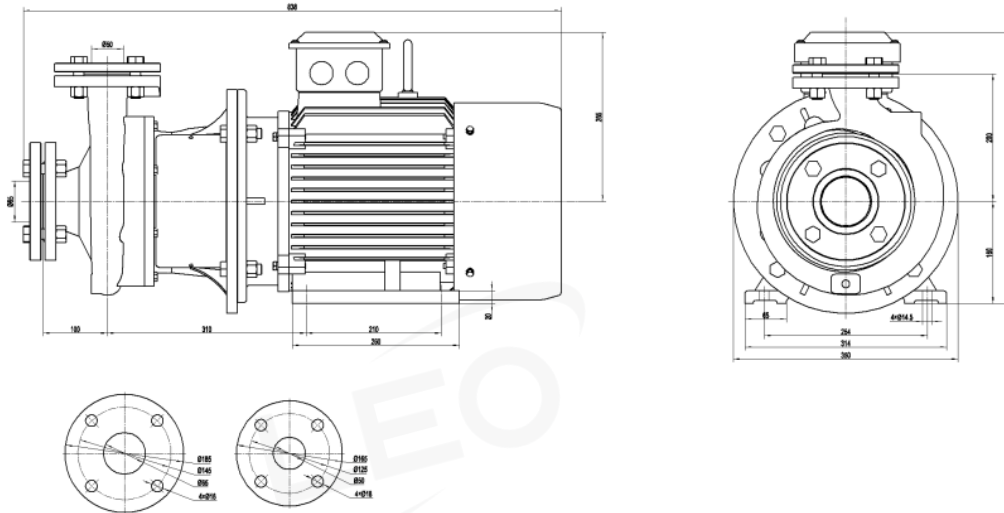

## Exploded View

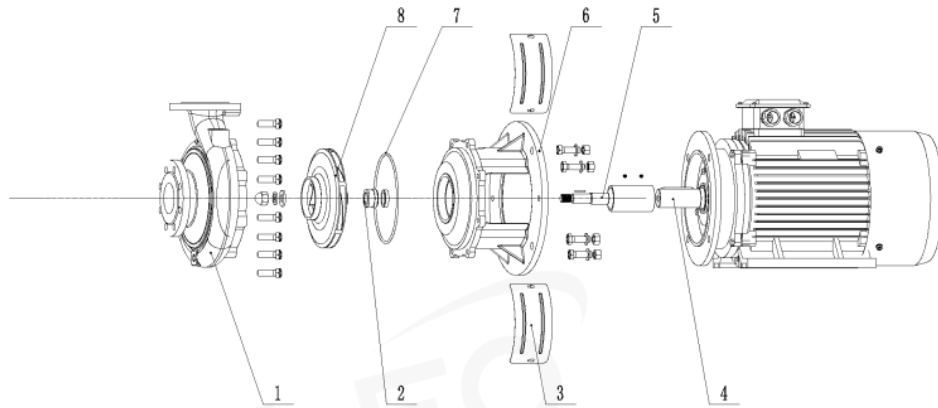

8	Impeller	AISI304
7	O-ring	NBR
6	Pump shaft	BT200
5	Pump shaft	AISI304/45
4	Motor	Motor
3	Baffle	AISI304
2	Mechanical seal	
1	Pump inlet	BT200
No.	Name	Material
	Part Name	



## LEO PUMP GROUP CO.,LTD.

📍 Headquarter Address:  
No.505,23rd Street,Qiantang District,Hangzhou,Zhejiang,310020, P.R.China

Base Address:  
No.1,3rd Street,East Industry Center, Wenling,Zhejiang,317511,P.R.China  
No.9 Jiuhua Road,Jiuhua Eco-Tec Development Area,Yuhu District,Xiangtan,Hunan,411202,P.R.China  
No.19 Changshun Road,Changcheng Street,Lushunkou District,Dalian,Liaoning,116049,P.R.China

🌐 [www.leopump.com](http://www.leopump.com)      ✉ [export@leopump.com](mailto:export@leopump.com)

☎ +86-576-8998 6556      📠 +86-576-8998 9898

\* LEO reserves all the right of products modification without prior notification



Exploring More by Scanning!