

## C 2-15 WF

3-part drill-in hinge for timber doors



### Technical data

Property	Value
Load capacity	60,0 kg
Knuckle length	75,0 mm
Knuckle Diameter	15,0 mm
Pin diameter	8,0 mm

### Notes

The load capacity mentioned above refers to the use of 2 hinges per door leaf (1 x 2 m), for detailed information please look at the chapter "technical information".

Also available with security pin (MSTS).

Casing frame: Application accessories on request.

Other finishes available on request.

### Installation tools

Drilling jig BAKA 13/15

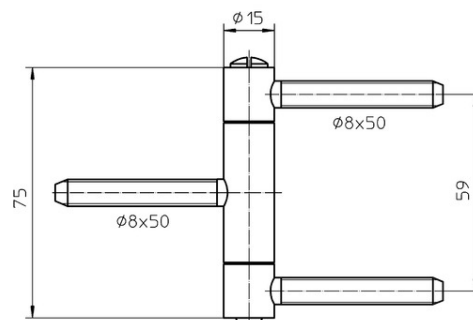

front view

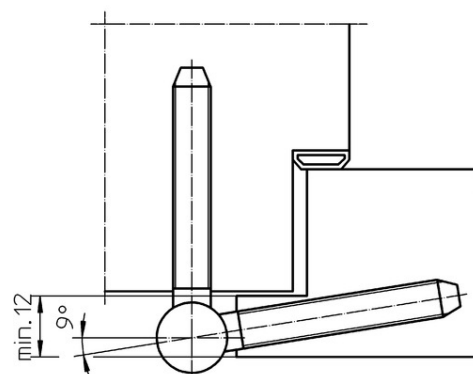

cross section

**BAKA - C 2-15 WF****Combinations**

Decorative sleeve no. 2-2 ZK

**Item versions**

Finish	nickelled (SW 015)
VPE	pack of 20
DIN	DIN right and left hand
Article number	5 080627 0 01507
EAN	4015471012090
Finish	Satin Stainless Steel (SW 040)
VPE	pack of 20
DIN	DIN right and left hand
Article number	5 080627 0 04007
EAN	4015471040710
Finish	Topzinc (SW 110)
VPE	pack of 20
DIN	DIN right and left hand
Article number	5 080627 0 11007
EAN	4015471040697