

Environmental tips



Please dispose of the package, used components (battery) and hazardous fluid (antifreeze and machine oil) properly according to local waste disposal regulations to ensure environmental safety.



Please remember to recycle them for further use if possible.

VinnerMyer

RIDE-ON FLOOR SCRUBBER

S810R

Product Manual

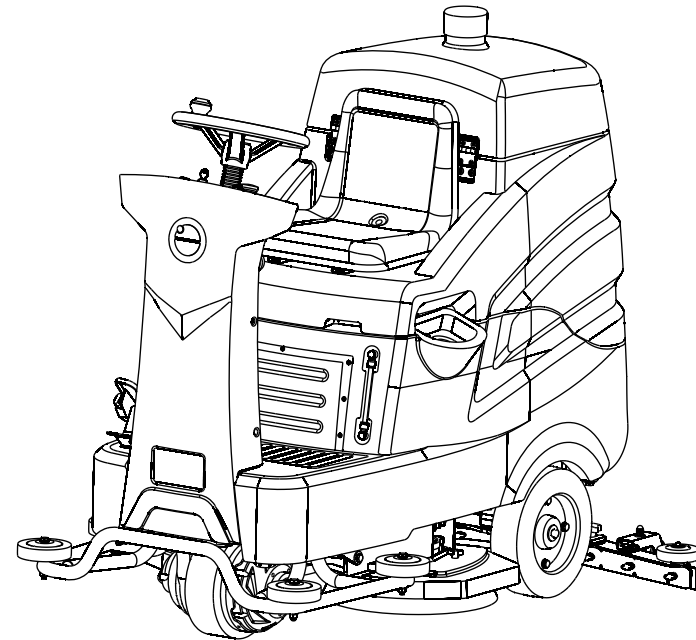

This manual contains important safety precautions and instructions on the correct operation of product. Please read this carefully before using the product.

Version: A/0-2020

IMPORTANT STATEMENT

The content of this manual is for all users. Manufacturer reserves the right to update and revise the content of this manual as when necessary. If there will have further inquiries, please contact the distributor or manufacturer.

NOTE

Batteries and chargers mentioned in this manual are options, which are not included in the sales and after-sales service of this product.

S810R Ride-on Floor Scrubber Optional Spares

Description: The following pictures are only for reference, so products are subjects to what you get.

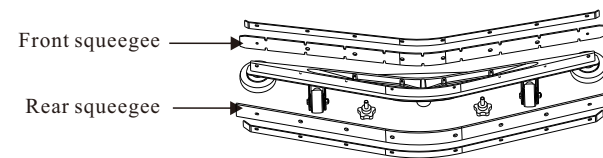

- ☐ Front squeegee: standard squeegee
- ☐ Front squeegee: oil-resistant squeegee
- ☐ Front squeegee: customized hole position
- ☐ Rear squeegee: standard squeegee
- ☐ Rear squeegee: oil-resistant squeegee

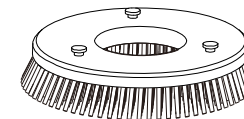

- ☐ Brush: 16" brush with 0.5mm bristles
- ☐ Brush: 16" brush with 0.4mm bristles

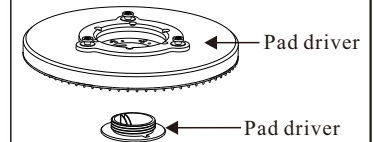

- ☐ Pad driver: 16" floor scrubber pad driver

Remark: _____

WARRANTY INFORMATION

Disclaimer

Manufacturer takes no responsibility under the following cases:

1. Any damage due to inadequate use of power supply.
2. Any damage due to alteration by unauthorized agents.
3. Any damage of parts due to improper use, storage or handling of machine.
4. Any damage due to operating machine under adverse conditions.
5. Any damage due to overloading to machine.
6. Any damage due to unattended safety precautions before leaving the machine.
 - Stop on level surface.
 - Set parking brake.
 - Turn off machine and remove key.
7. Any machine damage or personal injury due to use other types of charger.
8. It is not intended for use by persons (including children) with reduced physical, sensory mental capacities, or lack of experience and knowledge. Children should be supervised to ensure that they do not play with the appliance.

Thank you for buying this product. Before operating it, please read this manual completely and carefully to make sure that you are familiar with the product and can assemble components correctly. Please save this manual for future reference.

Description:

Function: Floor scrubbing.

For area: Smooth hard ceramic tiles or marble floor in shopping malls, hotels, residential places, etc.

Description of symbols in this manual



Warning

Content starting with this symbol is information closely related to operator's safety. If this symbol appears in a certain chapter, it refers to relevant information starting with the "Warning" sign and it should be read carefully.



Attention

Content starting with this symbol indicates possible causes of failure of the product. If this symbol appears in a certain chapter, it means relevant message with an "Attention" symbol should be read carefully.



Note

Content starting with this symbol provides supplementary information.

Description of symbols on the machine



It means important notes to be followed during operation.



Stay away from naked fire.



Stay away from flammable source and corrosive liquids.



Indicates high power voltage and the area should be kept from water spill.



Please read the operating manual and instructions on use before starting the product.



The maximum temperature of cleaning water is 50°C.

CONTENTS

Packing list

Standard configuration.	1
---------------------------------	---

Operation instructions

Key components.	2
Description of control components.	4
Control panel.	4
Assembling parts.	6
Preparation before starting the machine.	8
Operation steps.	9

Safety precautions

Don'ts.	10
Notes before using.	10
Precautions.	11

Important precautions

Working conditions.	12
Notes on ridding.	12

Maintenance guide

Daily maintenance.	13
Periodic maintenance.	16
Trouble shooting	17

Technical details

Technical specifications	19
Wiring diagram.	20

After-sales service

After-sales service	21
Limited warranty statement.	21
Disclaimer.	22

AFTER-SALES SERVICE

After-sales service

If there are any questions, contact local after-sales service agent or manufacturer at: 020-86060888.

Warranty card	Fill out the warranty card after purchasing the product and store the warranty card for future use.
Under warranty	Provide the after-sales service agent with the warranty card, the invoice and the part that needs to be repaired.
Exceed warranty period	The after-sales service agent repairs the product and charge according to situations.

The product must be repaired by manufacture's approved after-sales service agents.
The name list of after-sales service agents can be found on our website:
<http://www.byclean.net>.

Limited warranty statement

1. Manufacturer's authorized distributors are responsible for the after-sales service of the product.
2. Recommended replacement intervals and duration of limited warranty of spares and consumables are as follows:

Name	Recommended replacement intervals	Name	Recommended replacement intervals
Vacuum motor	600hours	Plastic hoses	/
Other motors	1200hours	Brush assembly	100hours
Some electric components	/	Bumper wheel	1000hours
Common electric components	/	Squeegee	200hours
Other electric components	/	Other rubber components	/
Filter	800hours		
Gear chain	1000hours		
Wheel	/		

TECHNICAL DETAILS

Wiring diagram

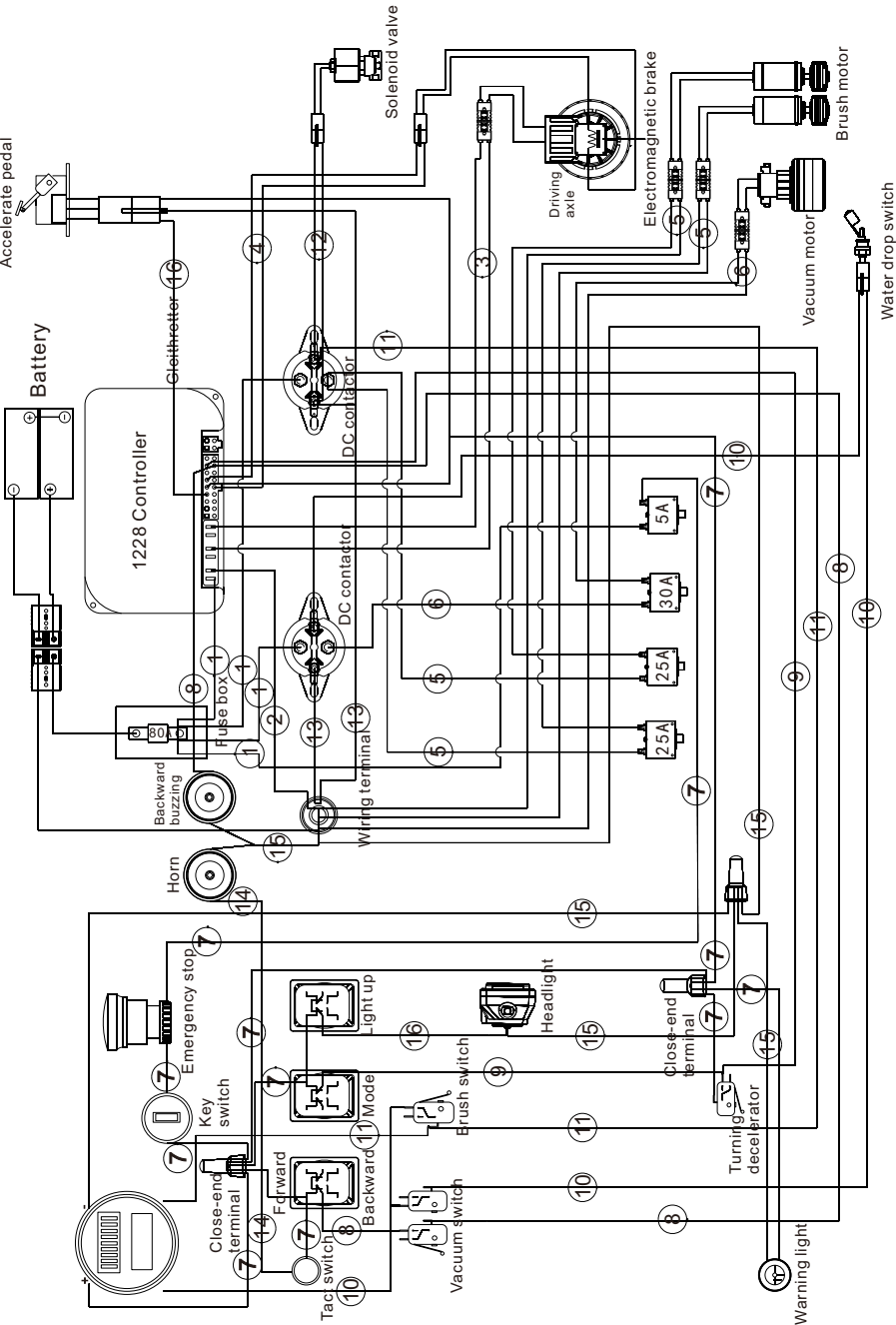

PACKING LIST

Standard configuration

NO.	Name	Unit	Quantity
1	Main unit	Piece	1
2	Squeegee assembly	Set	1
3	Product manual	Copy	1
4	Conformity certificate	Piece	1



Batteries and chargers are not included in standard configuration. Optional batteries and chargers will be packed in separate cases if purchased.

•Unpacking check

Check the product receiving immediately. If there will be obvious damages on the product, please keep the packing materials and contact the local distributor.

OPERATION INSTRUCTION

Key components

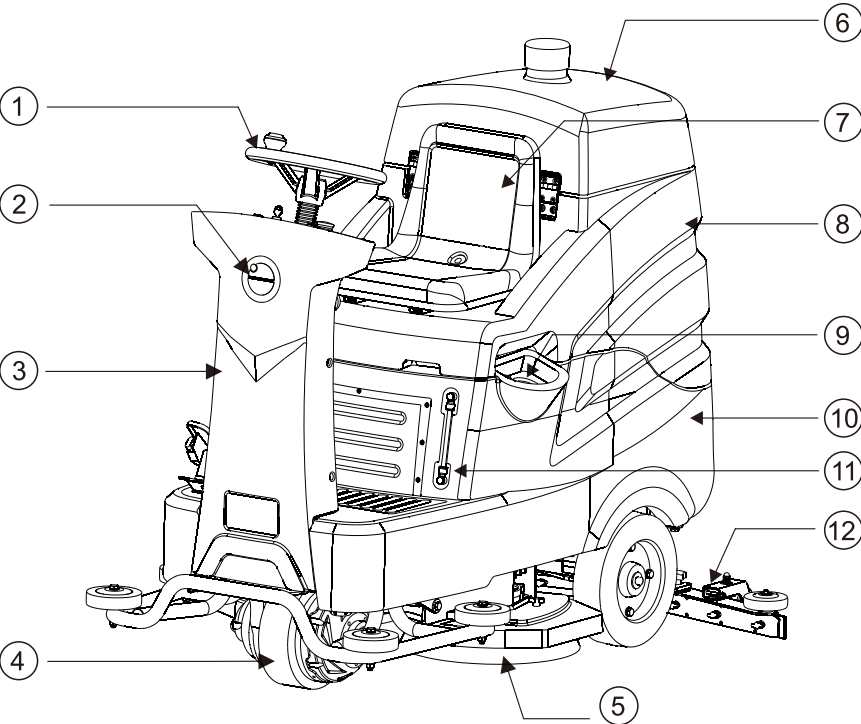

- | | | |
|---------------------|-----------------------|-----------------------|
| ① Steering wheel | ⑤ Brush assembly | ⑨ Solution tank inlet |
| ② LOGO | ⑥ Recovery tank cover | ⑩ Solution tank |
| ③ Console | ⑦ Seat | ⑪ Solution gauge |
| ④ Front drive wheel | ⑧ Recovery tank | ⑫ Squeegee assembly |

TECHNICAL DETAILS

Technical specifications

Description	Unit	Data
Protection level	IPX	3
Operating voltage	VDC	24
Vacuum motor	W	550
Suction power	mmH ₂ O	1720
Brush motor	W	300W x 2
Brush speed	rpm	180
Traction motor	W	650
Driving speed	km/h	0-6
Noise level	dB	≤70
Solution tank capacity	L	100
Recovery tank capacity	L	110
Maximum solution supply	L/min	3
Squeegee width	cm	100
Theoretical working capacity	m ² /h	4800
Brush diameter	inch	16
Cleaning width	cm	81
Brush pressure	kg.f	≥25
Maximum gradeability	%	10
Minimum turning radius	cm	130
Machine dimension(without squeegee)	cm	155x88x135

*Protection type: overload current protection, short circuit protection, power-down protection.

MAINTENANCE GUIDE

Trouble shooting

Note: Before contacting the repair agent or our customer service department, please check the followings for possible solutions.

Problem	Cause	Solution
The brush does not work and the buzzer keeps buzzing.	1. The load of the brush motor is too strong. (The electricity current is over 49A)	1. Switch off the machine and adjust the pressure between the brush and the floor. Then, restart the machine.
The horn does not sound, the solenoid valve does not work.	1. The horn, solenoid valve are overprotective.	1. Switch off the machine for 2minutes and restart the machine.

OPERATION INSTRUCTIONS

Key components

- ⑬ Drain hose
- ⑭ Suction hose
- ⑮ Rear wheel
- ⑯ Control panel
- ⑰ Squeegee lever
- ⑱ Brush lever
- ⑲ Power socket
- ⑳ Accelerator pedal

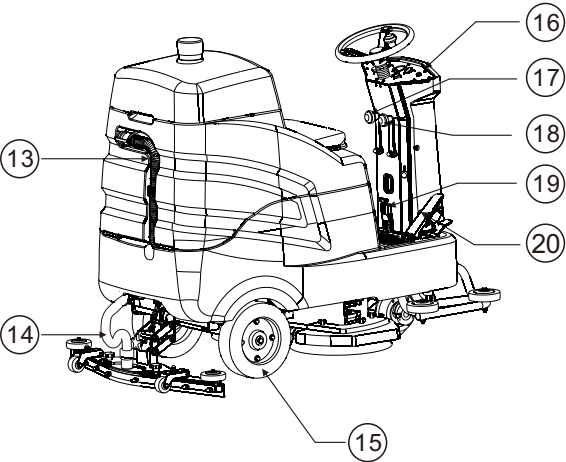

- ㉑ Supporting rod
- ㉒ Battery assembly (Optional)

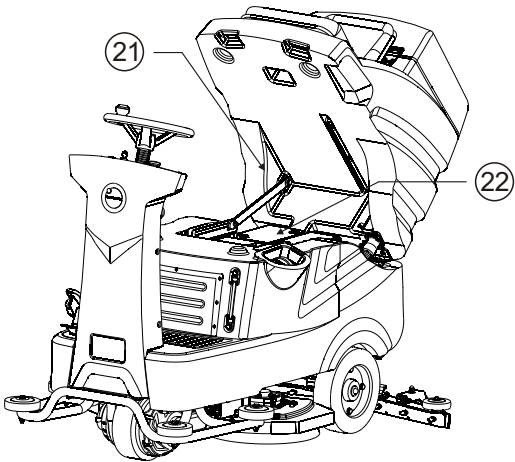

OPERATION INSTRUCTIONS

Description of control components

1. Steering wheel: Control the direction of the machine.
2. Control panel: Functional keys operation.
3. Brush lever: Lift the lever to raise the brush. And lower the brush by lowering the lever.
4. Squeegee lever: Lift the lever to raise the squeegee. And lower the squeegee by lowering the lever.
5. Accelerator pedal: Step the pedal to speed up the machine. Release the pedal to slow down the machine.
6. Solution flow lever: Lift the lever upward to increase solution flow. Lower the lever downward to decrease solution flow.

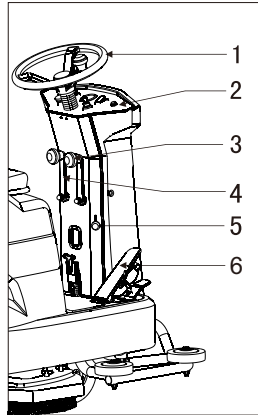

Control panel

① Main power switch

Inert key and turn it clockwise to switch on the machine. And turn the key anti-clockwise to switch off the machine.

② Emergency stop

When the machine is moving, press it to cut off the power and stop the machine immediately.

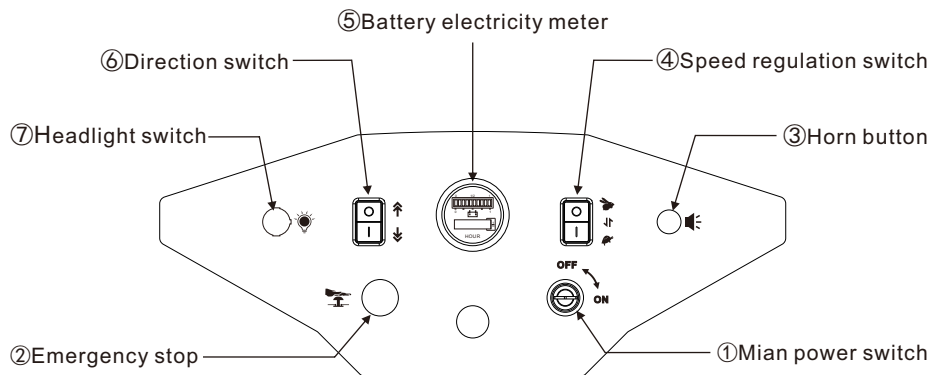

fig. 1

MAINTENANCE GUIDE

Trouble shooting



Note: Before contacting the repair agent or our customer service department, please check the followings for possible solutions.

Problem	Cause	Solution
The motor does not run.	<ol style="list-style-type: none"> 1. The related switch has not been turned on. 2. The voltage of the machine is not normal or stable. 3. The related indicator light flashes. 	<ol style="list-style-type: none"> 1. Switch on the related motor switch. 2. Make sure the machine is working with stable voltage. 3. Restart the machine.
No solution comes out or the solution flow is small.	<ol style="list-style-type: none"> 1. The filter or connector is obstructed. 2. The floor is too dry. Solution supply is insufficient when cleaning a new building for the first time. 3. The solenoid valve is obstructed. 4. The solenoid valve is overprotective. 5. The silicone hose is bended. 	<ol style="list-style-type: none"> 1. Remove the filter and the connector and clean them. 2. When the ground is too dry, sprinkle some water on it before cleaning. 3. Clean the solenoid valve. 4. Turn off the machine for 2 minutes and restart the machine again. 5. Straighten the silicone hose.
Vacuuming is weak.	<ol style="list-style-type: none"> 1. The seal ring of the recovery tank lid failed. 2. The hose clip loosened. 3. The vacuum motor loosened. 4. The suction hose is obstructed. 5. The suction hose is broken. 	<ol style="list-style-type: none"> 1. Attach the seal string properly. 2. Check the hose clip and install it properly. 3. Open the silencer lid, make sure the motor is installed correctly and properly. 4. Clean out the air inlet and outlet. 5. Repair the suction hose.
The terminals of the batteries become hot or fused.	<ol style="list-style-type: none"> 1. The cable are not tightly screwed. 	<ol style="list-style-type: none"> 1. Tighten the screw.
Soiled water could not be completely sucked.	<ol style="list-style-type: none"> 1. The suction hose is obstructed. 2. There are foreign objects in the squeegee. 3. The squeegee is excessively worn out. 4. The height of the squeegee is not suitable. 5. The vacuum motor does not work. 	<ol style="list-style-type: none"> 1. Remove the foreign objects. 2. Remove the foreign objects 3. Use another side of the squeegee or replace the squeegee. 4. Adjust the height of the squeegee. 5. Check the motor.
The machine could not clean thoroughly	<ol style="list-style-type: none"> 1. The brush motor does not run. 2. The dirt is too stubborn. 3. The brush is excessively worn out. 4. The brush is obstructed by a foreign objects. 	<ol style="list-style-type: none"> 1. Check the motor. 2. Use special effect detergent and sprinkle it on the floor. 3. Replace the brush. 4. Remove the foreign objects.

MAINTENANCE GUIDE

Period maintenance

1. Apply lubricating grease or oil the moving components regularly.
2. Apply electrostatic oil or kerosene oil regularly to frequently used strong current sockets to prolong their service life.



Note

Apply lubricating grease to areas shown below at recommended intervals.

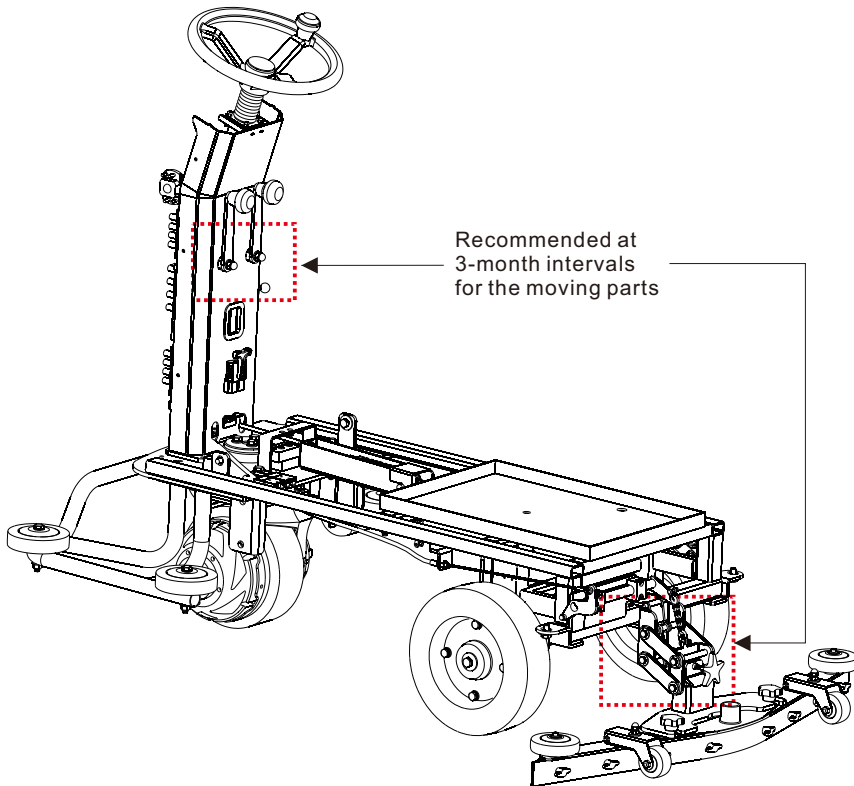

OPERATION INSTRUCTIONS

Control panel

- ③ Horn button
Press it to sound the horn. Release it to stop the sound.
- ④ Speed regulation switch
Turn on the power and press the "○" of this switch to change the machine to high speed. And press the "└" of this switch to change the machine to low speed.
- ⑤ Battery electricity meter
Turn on the power, the battery electricity and working hours will display on the meter.
- ⑥ Direction switch
Turn on the power and press the "○" of this switch, the machine will move forward. Press the "└" of this switch, the machine will move backward.
- ⑦ Headlight switch
Turn on this switch, the headlight will flash. Turn off this switch, the headlight will go out.

OPERATION INSTRUCTIONS

Assembling parts

1. Squeegee assembling

Turn the star nuts anticlockwise to unfasten them. Then slide the bolts of the star screws into the slots of the squeegee lifting plate and use the star nuts to fasten the assembly by turning them clockwise. After that, connect the suction hose with the suction inlet on the squeegee.

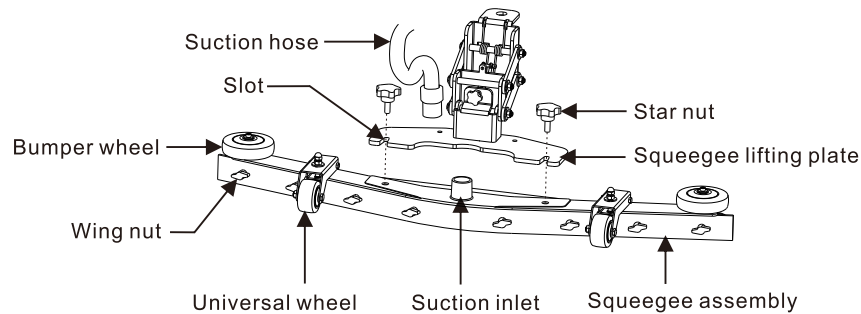

2. Battery assembling

(Battery is not included in standard configuration.)

! Attention

- 1.The batteries can be very dangerous if not connected or assembled correctly, so let the trained personnel help.
- 2.It is necessary to tilt open the recovery tank to reach the batteries. Drain all the soiled water in the recovery tank before turning it.
- 3.Fix the recovery tank firmly after opening it to avoid dangers of closing accidentally.
- 4.To prevent dangers, check the batteries and accessories before assembling them.
- 5.Make sure the machine is switched off.
- 6.Stay away from fire.
- 7.Assemble the batteries in ventilated place.
- 8.Put the batteries in position with care, and connect them correctly with proper cables.

Steps:

- 1.Empty all the soiled water and turn over the recovery tank as shown below.(fig.3)
- 2.Connect the batteries with proper wires as shown below(fig.4):Connect the cathode to the anode as shown.
- 3.Turn the recovery tank back(fig.5).
- 4.Connect the battery socket to the machine socket(fig.5).

MAINTENANCE GUIDE

Daily maintenance

4.Maintain the brush

Lift the brush lever to raise the brush assembly. Then hold the brush with two hands and turn it 30° anti-clockwise quickly to remove the brush for cleaning. If the machine will stay idle for a long time, the brush should be removed, cleaned and air-dried. Otherwise, the prolonged loading to the brush motors may cause failure or be unable to function properly.

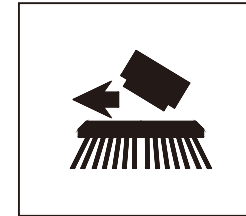

fig. 13

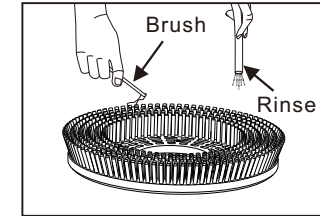
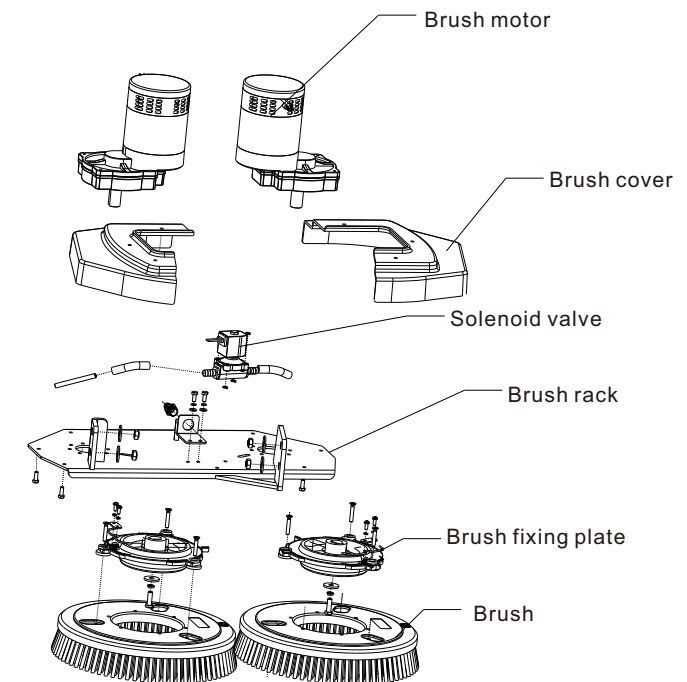

fig. 14

●Brush assembly exploded diagram



MAINTENANCE GUIDE

Daily maintenance

3. Maintain the squeegee

Remove, clean and air-dry the squeegee regularly to prolong its service life. The whole squeegee assembly can be removed for cleaning and air-drying.

❗ Attention: Don't dry the squeegee by exposing it to sunshine.

The procedure to remove the squeegee:

1. Turn the two star nuts anticlockwise to remove the squeegee assembly.
2. Release the wing nuts. Then the front and rear squeegee can be removed.

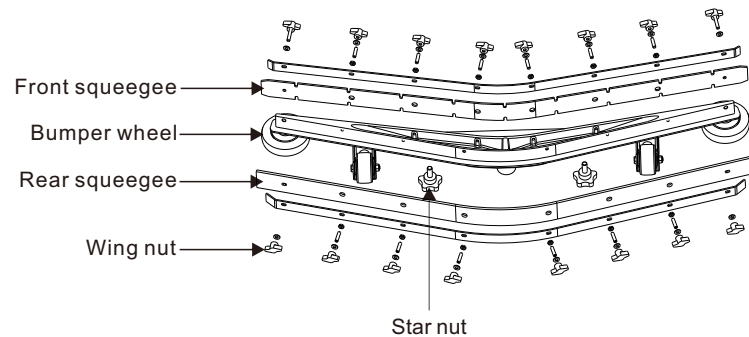

OPERATION INSTRUCTIONS

Assembling parts

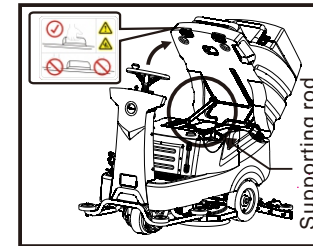

fig. 3

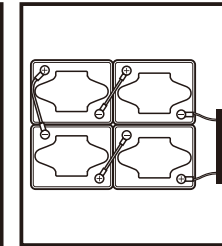

fig. 4

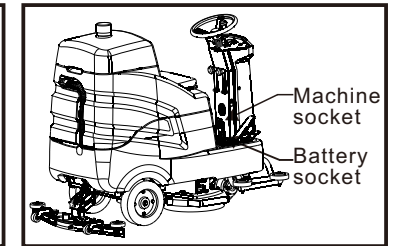

fig. 5

3. Brush assembling

❗ Attention

- Do not press the function buttons when hands are contacting the brush to avoid injuries.
- Make sure the scrub pad is placed with the center of the pad driver and screw the pad driver buckle. Afterwards, you can work as follows.

1. Lift up the brush lever to ascend the brush cover. Then, push brushes under the brush cover to keep proper distance between them. Then, hold the brush to make the brush holder under the center of brush cover. After that, put down the brush on the floor vertically (fig.6).
2. After positioning the brushes, lower the brush lever to start the brush motor. Then, the brush will become circling until it cooperates with the brush holder and assemble themselves on the brush cover (fig.7).

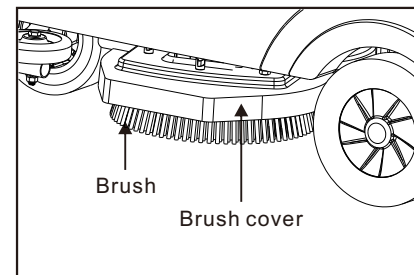

fig.6

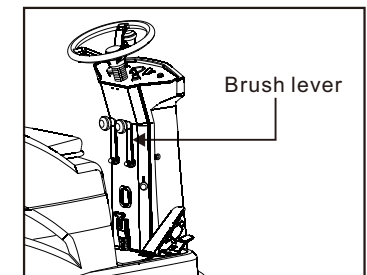

fig.7

OPERATION INSTRUCTIONS

Preparation before starting the machine

1. Fill the solution tank

- (1) Open the lid of the solution tank, then fill water or dilute neutral detergent into it.
- (2) Observe the solution gauge to see whether the amount of solution is enough for the cleaning work. (Do not over-fill the tank.)
- (3) The temperature of water filled into tank should not be higher than 50°C.

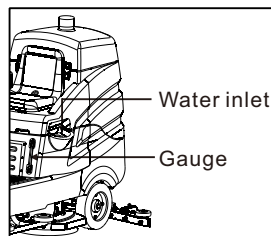

! Attention

To avoid shortening the service life of the machine, detergents added into the solution tank should be less foamy and less volatile neutral detergents with a PH of 5-9. When using detergents, defoamer should be added into the recovery tank to prevent the foamy with dirt flowing into the vacuum motor to damage the motor.

- ### 2. Check whether the brushes are well assembled. If not, assemble them according to the instructions of "Brush assembling" on Page 7.

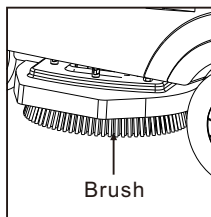

- ### 3. Check whether the squeegee assembly is well assembled. If not, assemble them according to the instructions of "Squeegee assembling" on Page 6.

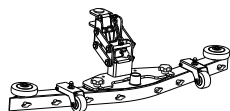

- ### 4. Connect the battery socket well with the charger socket when charging batteries. If not, the batteries will not be charged. Disconnect the battery socket from charger socket after charging batteries. And connect the battery socket with the machine socket.

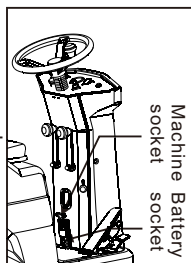

- ### 5. Use the key to turn on the ON/OFF switch and turn the emergency stop button right.

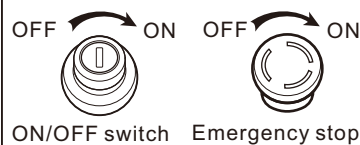

- ### 6. Check whether the power of batteries is enough for the cleaning work. Then lower the squeegee lever and brush lever to make sure the brushes and squeegee are ready for work.

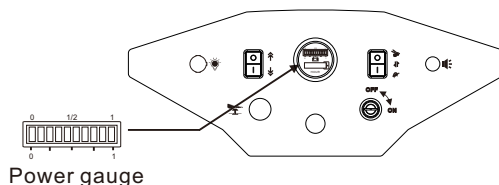

MAINTENANCE GUIDE

Daily maintenance



Attention

When the cleaning work is over:

1. Disconnect the machine socket from the battery socket.
2. Drain the soiled water from the recovery tank and wash it with clean water.
3. Check and make sure the suction hose is clear.
4. Wash the brushes and squeegees and air-dry them.

1. Maintain the recovery tank

- Clean the recovery tank every time the cleaning work is finished. Then drain all the soiled water in the recovery tank. After this, use clean water to wash the recovery tank, and air-dry it. Keeping the recovery tank clean can prevent sludge or foreign objects from blocking the tank.

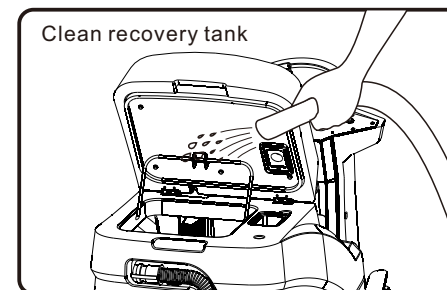

fig. 11

2. Maintain the solution tank

If the machine will not be used for long time or will be stored or in transit under the temperature below 4°C, take out the solution gauge and drain all the solution in the solution tank in order to prevent solution from changing state. After this, remove the cover of the filter. Then, press the sprinkling button to drain all the solution stayed in the sprinkling system and clean the filter if necessary. Frozen solution in the sprinkling system, solenoid valve and the hoses will cause damage to machine (fig. 12).

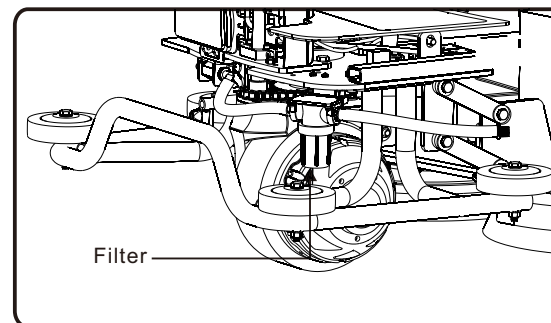

fig.12

IMPORTANT PRECAUTIONS

Working conditions

1. Working environment temperature

- The machine works best in -10°C to +35°C indoor environment.

2. Sensibility to strong acid and strong alkali

- Do not put strong acid or strong alkali liquids into the solution tank to deal with stubborn dirt, in case those liquids damage the components of the solution channel. If those liquids are needed, they can be sprinkled on the floor directly.
- The detergents put into the solution tank should be neutral detergents with a PH of 5-9.

3. Cleaning areas

- If there are too much dirt and big rubbish on the floor, such as wastepaper, plastic bags, fruit peel, fruit seeds and so on, it is recommended to sweep the floor first and then use the machine to clean the floor, in order to avoid big foreign objects block the suction hose.

Notes on ridding

1. While driving, prevent the machine from bumping with other objects. Before entering a narrow space, check and make sure the machine can get through
2. Driving the machine on rough places may cause damages, which will shorten the service life of the machine. Please keep away from falling objects or the places with potentially dangers. Take on a helmet in the place where falling objects may occurs .
3. The height of the barrier must be less than 10mm for the machine to get through. If the height of the barrier is over 10mm, turn the machine back and drag the machine through the barrier. Do not bump the machine straightly. It is necessary to build a ramp when the barrier is too high that the machine can not get through.
4. The width of the aisle should be at least 108cm for the machine with the squeegee assembly to get through. If the width of the passage is less than 108cm, remove the squeegee assembly, and then let the machine get through. Do not force the machine to get through, which may cause damages to the machine. Lift the squeegee assembly when moving backward.
5. When turning, slack up on the pedal to avoid rollover.

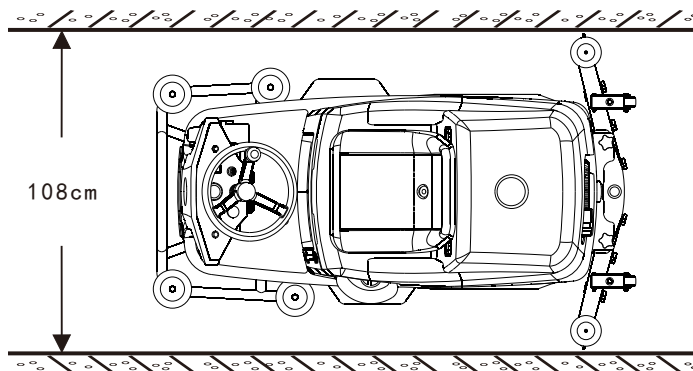

OPERATION INSTRUCTIONS

Operation steps

After the preparation work, operator can begin the cleaning work.

1. Firstly, turn on the ON/OFF switch and turn the emergency stop switch clockwise.

2. Keep a proper speed according to the situation. And lower the brush lever and squeegee lever to do the cleaning work.

4. Drain and clean the recovery tank before refilling it or after the cleaning work. Turn off the ON/OFF switch to stop all running work after the cleaning work.

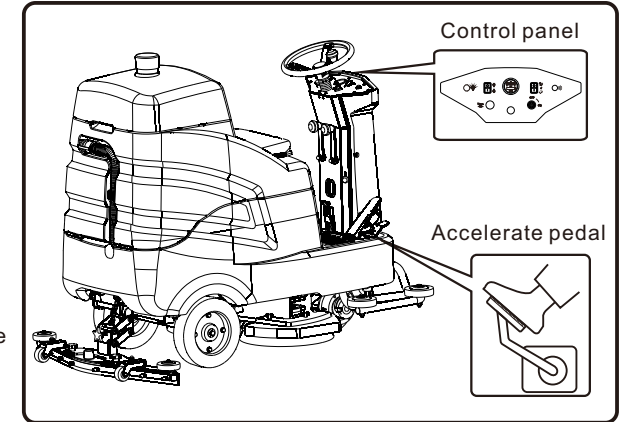

SAFETY PRECAUTIONS



This chapter contains important information about the safe use of the machine.
Please read it carefully.

Don'ts

1. Do not put anything on the machine;

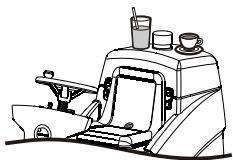

Forbidden

2. Do not put hands into the spinning parts while the machine is operating;

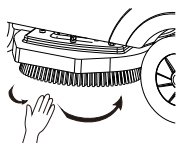

Forbidden

3. Do not block the air-discharge hose or the air ventilation area;
Do not move, change or cover the safety information sign;



Forbidden

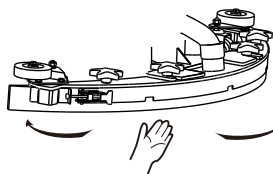

Forbidden

5. To ensure personal safety, the machine must be operated by a trained technician. (New users can be trained the basic operation skills in the field by sales agent or distributor.)

Notes before using

1. This machine is designed for small or medium area floor cleaning indoor or outdoor.
Please read this manual thoroughly and carefully before starting the machine.
2. Do not disassemble or refit the machine without permission. This is an engineering design product and is tested in production. Manufacturer takes no responsibility for accidents or damage as a result of unauthorized disassembling or refitting the machine.
3. Make sure the voltage of power supply accords with the nameplate of the machine.
Manufacturer takes no responsibility for damage or human injuries caused by using wrong power supply.
4. Do not overload the machine. Manufacturer takes no responsibility for damage to any components as a result of overloading.
5. Do not use the machine under adverse condition, such as acid/alkaline rich area, working temperature lower than -10°C or above +35°C. The manufacturer takes no responsibility for damage, accidents or injuries as a result of operating the machine under adverse conditions.
6. It is unsuitable for operating work when there is hidden trouble in the machine. Before operation, ensure all functions of the safety device are normal.
7. In case of any abnormalities, please contact authorized after-sales service center immediately.

SAFETY PRECAUTIONS



Warning

Safety precautions

1. If problem happens while the machine is operating, cut off the power first. After having inspected and solved the problems, restart the machine again.
2. The end of the battery cable should connect to the terminal holders of the battery directly to ensure safety. If there is a metal pad between them, the temperature of the battery and the cable may become too high and, even worse, the battery and the cable may fuse or damaged.
3. Turn over the recovery tank and fix it when batteries charging to achieve better heat ventilation. (Empty the soiled water in recovery tank before turning it over)
4. Water spilling to the inner parts and the control panel should be avoided when cleaning the machine. Otherwise, water ingressing may cause short circuit. (fig.9 & fig.10).

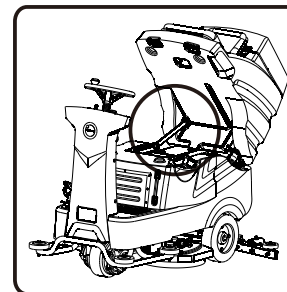

fig. 8

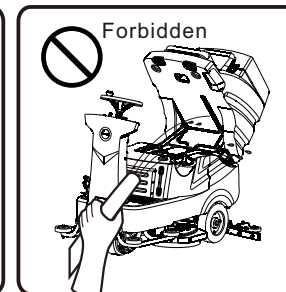

fig. 9

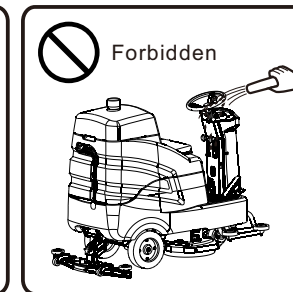

fig. 10

5. Do not inhale exhaust gas or use the machine near flammable liquids, gas or suspended particles.
6. Batteries should be charged outside the machine. Keep the machine from any heat source and make sure it is ventilated.
7. Disconnect the battery socket from the machine socket and disconnect the battery socket from the charger socket before maintaining the machine.
8. This machine can only be assembled with brushes of the designated size. Being assembled with brushes of other sizes may result in damage to the machine.
9. Be careful and move the machine at the low speed when it is working on slopes or sliding floor, especially when it is moving backward.
10. Release the accelerator to slow down when the machine turns around. If not, it may overturn.
11. Do not keep the machine scrubbing one place for a long time, otherwise, the area/floor may be damaged.
12. To prevent the machine from unauthorized operating, pull out the key switch to turn off the power.
13. Make sure the machine will not move accidentally when it is left unattended.
14. Before using the non-original batteries or chargers, contact the manufacturers in advance in order to avoid accidents.